



SCHLAGEL MFG \* 4154 BUTTERMILK ROAD \* TORRINGTON, WY 82240 \* PHONE: 307-532-4451 \* TOLL FREE: 888-889-1504 \* FAX: 307-532-8994

# PW-193NT “NO-TILL” POSI-CLOSE WHEELS INSTALLATION INSTRUCTIONS

**Made By Farmers...**  
**For Farmers**

**YOUR PW-193NT WHEELS WILL FIT THE FOLLOWING:**

JOHN DEERE MAX-EMERGE PLUS & XP & NEWER
KINZE PLANTERS (MODEL YEAR 1993 AND NEWER)
WHITE 6000 & 8000 SERIES
MONOSEM NG +2, +3, +4 (Or Older Monosem w/ upgrade)
GREAT PLAINS (NEWER) (including Twin Row)

Thank you for choosing SCHLAGEL'S NO-TILL POSI-CLOSE WHEELS to enhance your planting process. The following is a general instruction sheet for installation of PW-193NT posi-close wheels.

PW-193NT No-Till Posi-Close Wheels come fully assembled and ready to mount on your planter. One row of wheels consists of one (1) left-hand wheel w/ bearing and one (1) right-hand wheel w/ bearing. If parts are missing, damaged, or are not the correct style for your planter, call us toll free 1-888-889-1504 and we will get the problem fixed as soon as possible. When mounting your wheels, always keep the fingers pointed toward the inside (or towards each other), and the rods angled down when viewed from the rear of the planter. The diagram to the right shows a “rear view” of the wheels.

Your wheels mount with your existing 5/8” or 16mm bolt & nut through the closing wheel bearing. You will also re-use your existing spacers and/or washers between the hub and the planter’s tailpiece to adjust the wheel spacing. Variance in tailpiece tolerances, planter make, model, and spacers or washers that came with your planter may require you to get creative to get the recommended spacing. You might have to cut your own spacers or add more washers than your existing hardware includes.

**STAGGERED OR STRAIGHT-ACROSS:** Most newer planters have two holes to mount the wheels to—a front or rear hole—on each side of the tail piece. Testing has shown no pros or cons to either setting with our wheels, therefore we do not have a preference as to mounting our wheels in the staggered or straight-across position EXCEPT if you are going to mesh the wheels together, then the wheels must be straight across from each other.

**DRAG CHAINS... WE DO NOT RECOMMEND THE USE DRAG CHAINS WITH OUR WHEELS...**

*We have seen trash/debris building up under the drag-chain mounting bracket, thus locking up the wheels. So please remove drag chain and bracket prior to using our wheels. Call if you have any concerns regarding this.*

**Where should I set my wheels?**

After reading this, if you are unsure or have questions about where to set the wheels, call us for assistance. The wheels are designed to close the seed trench and firm the soil around the seed while leaving a

slightly raised, mulched mound directly over the seed.

**SETTING #1: SET APART (Diagram A)** Rods point towards each other and down when looking at the back of the planter. Most people set the wheels with 1/4” - 1/2” between the rods (wheels not meshed together) and this is a good place to start out under most conditions. This setting seems to work best in most soil conditions and tillage practices.

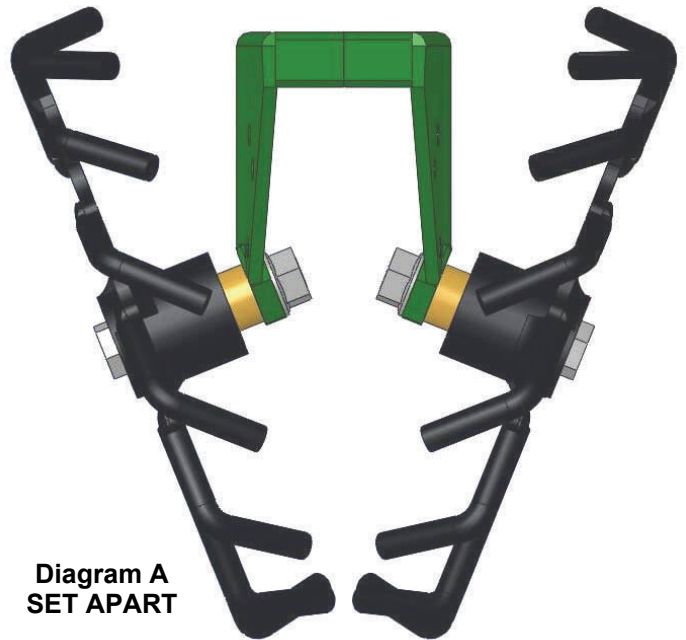

**Diagram A  
SET APART**

**SETTING #2: MESHED TOGETHER (Dia. B)** Rods point towards each other and down when looking at the back of the planter. If you are having trouble closing the seed trench, then try meshing the wheel rods together. Note that there is a certain point when the wheels will “lock up” when the wheels are slightly meshed together. If you mesh the wheels together, be sure to spin the wheels a few times to ensure they will not lock up. If they do lock up, you need to move the wheels a little closer together. Again—a reminder that the wheels must be mounted straight across from each other for meshing.

**KINZE PLANTER OWNERS:** On some Kinze planters, the tailpiece design will not permit moving the wheels together in a “meshed” configuration. We have a small bracket available (part # PW-227) that bolts onto your tailpiece that will permit meshing of the wheels. This would most likely be a last resort for you to consider since the majority of wheel users get by with the wheels set apart rather than meshed. If you feel you need a more aggressive setting for the wheels, then skip



**Diagram B  
MESHE  
TOGETHER**

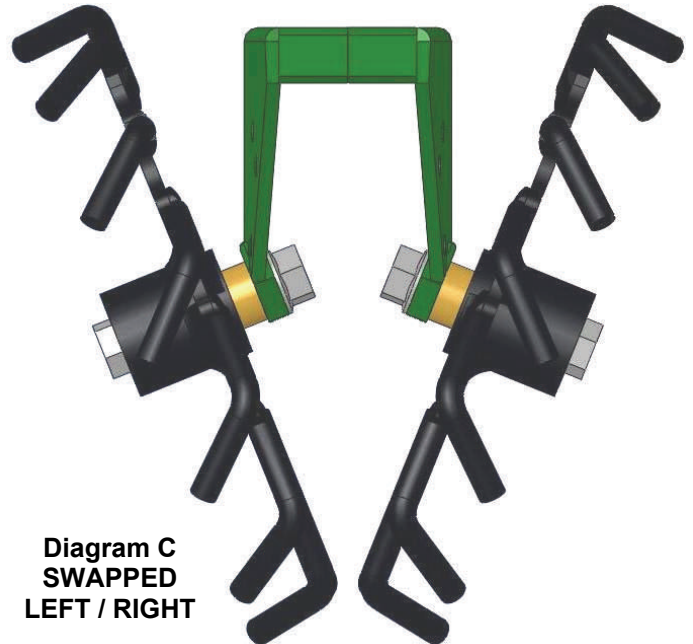

**Diagram C  
SWAPPED  
LEFT / RIGHT**

setting 2 and go to setting #3.

**SETTING #3: SWAPPING WHEELS LEFT TO RIGHT (Diagram C) Rods point away from each other and down when looking at the back of the planter.**

Swapping the wheels is probably the most aggressive at closing the seed trench because the tips of the rods hit the ground first. This is a good setting for hard no-till soil conditions. We have noticed that this setting leaves more chunky, mulched soil than the settings 1 & 2. Be sure your rods point the correct way—down when viewed from the back.

Note: Due to slight defects or discrepancies in tailpieces, the settings from one row to the next may differ. Also, we try to make all wheels perfect, but metal warps when welded—please keep this in mind. A little wobble won't affect the wheels' performance. It is common to have 1/8" or more wobble. However, if you feel your wheels have too much wobble, call us and we will replace if necessary.

Don't be afraid to call us (toll free 1-888-889-1504) if you have any questions.....we want our product to work well for you.

**Warranty Information**

Posi-Close Wheels come with a one-year limited warranty against parts and workmanship. **Please contact your dealer for warranty claims.** Have your original sales slip or invoice ready. They may need information from it.

**REPAIR PARTS**

Wheel Weldment (left-hand shown here)  
NOTE: REPAIR WHEEL "WELDMENTS" ARE NOT SOLD SEPARATELY (Wheels must be purchased with bearings pre-installed. See below)

- PW-193NTL: Left Wheel Assembly with bearing
- PW-193NTR: Right Wheel Assembly with bearing
- PW-193NT: Left / Right Pair of wheels

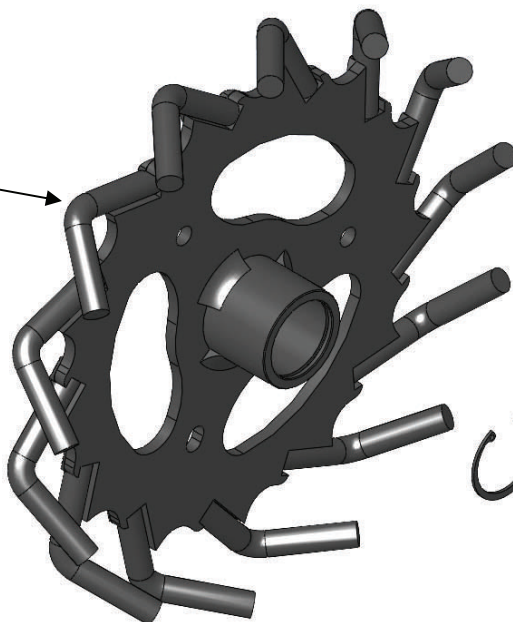

BEARING (Qty 1 per L/R wheel)

- Schlagel Part # HW-1390
- John Deere # AN212132
- Shoup Mfg # SH312132
- Peer Bearing # 5203KYY2

Snap Rings (1-9/16" bore size x 0.06") (qty 2 per wheel)

- Schlagel Part # HW-1364
- Common industry # HO-156

